

DESCRIPTION:
TYPICAL TRUSS CONNECTION

DATE: 15/5/03

DRAWN: BLG

SCALE: 1:10

SHEET:

15

SELECTED LIGHTWEIGHT ROOFING ON HD BUILDING PAPER ON
EX 100 x 50mm PURLINS @ 1100mm CRS ON TRUSSES @ 1200mm
CRS SKEW NAILED TO EX 100 x 50mm TOP PLATE WITH
2/100 x 3.75mm GALVANISED FLATHEAD NAILS

EX 100 x 50 mm TOP PLATE NAILED INTO TOP WALL
BOARD WITH 100 x 3.75mm GALVANISED FLATHEAD
NAILS @ 300mm CRS

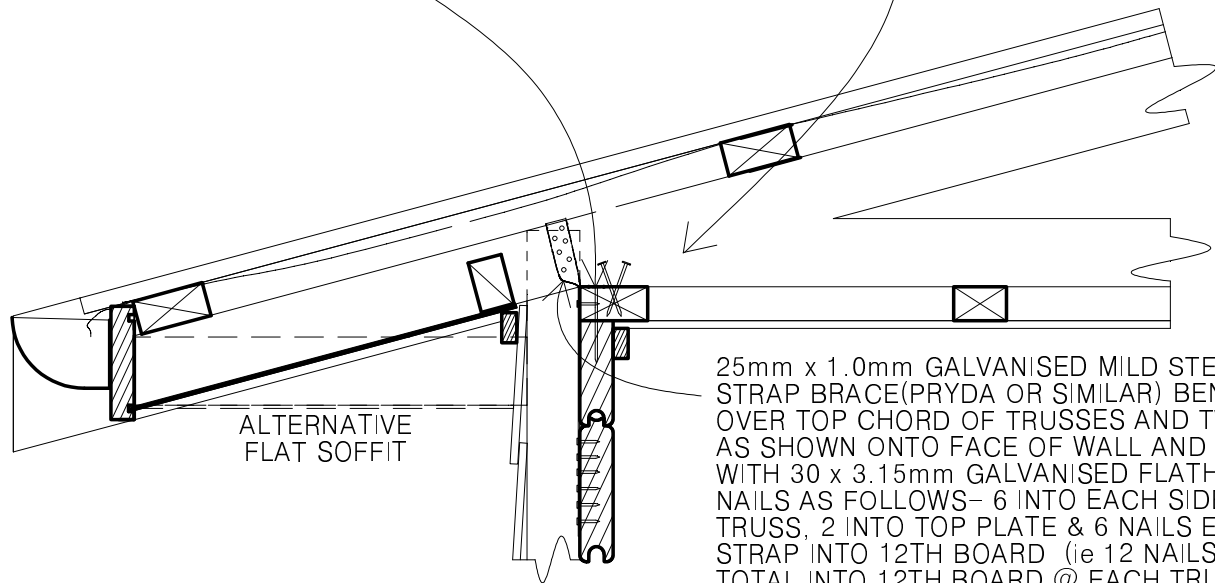

25mm x 1.0mm GALVANISED MILD STEEL
STRAP BRACE (PRYDA OR SIMILAR) BENT
OVER TOP CHORD OF TRUSSES AND TWISTED
AS SHOWN ONTO FACE OF WALL AND FIXED
WITH 30 x 3.15mm GALVANISED FLATHEAD
NAILS AS FOLLOWS - 6 INTO EACH SIDE OF
TRUSS, 2 INTO TOP PLATE & 6 NAILS EACH
STRAP INTO 12TH BOARD (ie 12 NAILS
TOTAL INTO 12TH BOARD @ EACH TRUSS
FIXING

© Frontier Solid Wood Homes Ltd 2003

NOTES:

DESCRIPTION:
TYPICAL RAFTER CONNECTION

DATE: 20/11/03

DRAWN: BLG

SCALE: 1:10

SHEET:

15.1

SELECTED LIGHTWEIGHT ROOFING ON HD BUILDING PAPER ON
EX 100 x 50mm PURLINS @ 1100mm CRS ON SELECTED RAFTERS
AS PER NZS3604 SKEW NAILED TO EX 75 x 50mm TOP PLATE WITH
2/100 x 3.75mm GALVANISED FLATHEAD NAILS

EX 75 x 50 mm TOP PLATE SCREWED INTO TOP WALL
BOARD WITH 100mm 10 GAUGE ZINC PLATED SCREWS
@ 600mm CRS

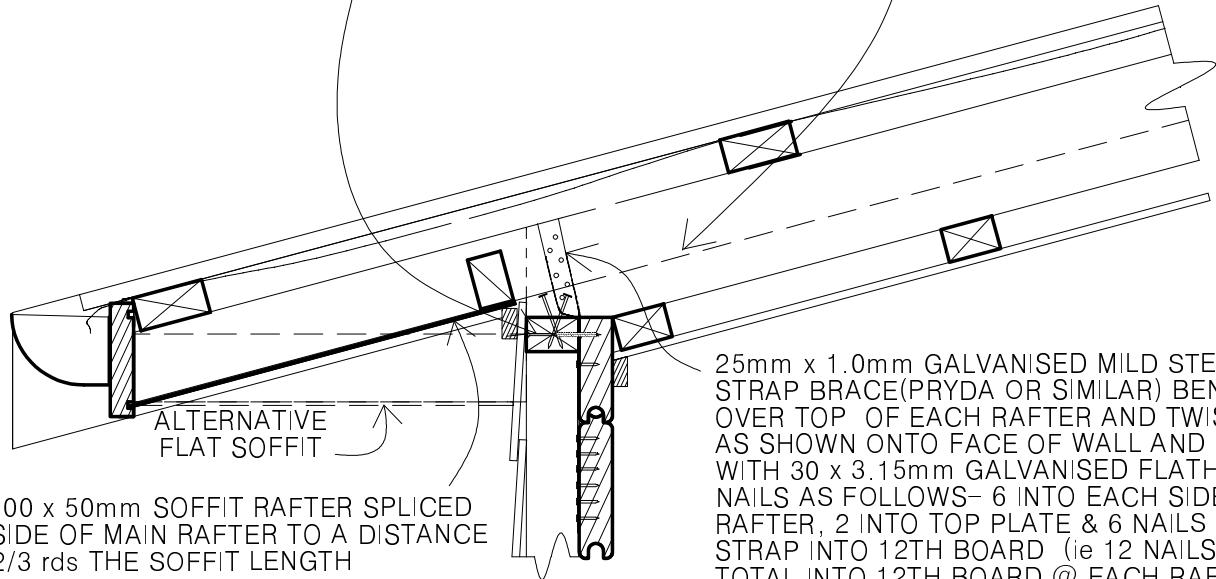

ALTERNATIVE
FLAT SOFFIT

EX 100 x 50mm SOFFIT RAFTER SPLICED
TO SIDE OF MAIN RAFTER TO A DISTANCE
OF 2/3 rds THE SOFFIT LENGTH

25mm x 1.0mm GALVANISED MILD STEEL
STRAP BRACE (PRYDA OR SIMILAR) BENT
OVER TOP OF EACH RAFTER AND TWISTED
AS SHOWN ONTO FACE OF WALL AND FIXED
WITH 30 x 3.15mm GALVANISED FLATHEAD
NAILS AS FOLLOWS- 6 INTO EACH SIDE OF
RAFTER, 2 INTO TOP PLATE & 6 NAILS EACH
STRAP INTO 12TH BOARD (ie 12 NAILS
TOTAL INTO 12TH BOARD @ EACH RAFTER
FIXING)

© Frontier Solid Wood Homes Ltd 2003

NOTES: